

# DIN 9021 - sim. ISO 7093

## Plain washers

with outside diameter ~ 3x nominal thread diameter

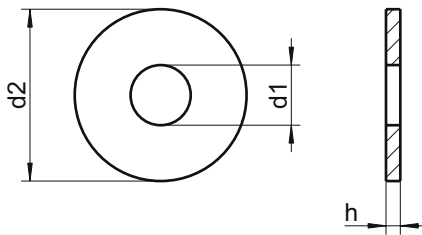

d1	for	d2	h
2,2	M2	7	0,8
2,7	M2,5	8	0,8
3,2	M3	9	0,8
3,7	M3,5	11	0,8
4,3	M4	12	1,0
5,3	M5	15	1,2
6,4	M6	18	1,6
7,4	M7	22	2,0
8,4	M8	24	2,0
10,5	M10	30	2,5
13,0	M12	37	3,0
15,0	M14	44	3,0
17,0	M16	50	3,0
20,0	M18	56	4,0
22,0	M20	60	4,0
26,0	M24	72	5,0
33,0	M30	92	6,0
39,0	M36	110	8,0

Grade	SU
▲●	1000
▲●	1000
▲●	1000
▲●	1000
▲●	1000
▲●	1000
▲●	1000
▲●	500
▲●	500
▲●	500
▲●	200
▲●	100
▲●	100
▲●	100
▲●	100
▲●	50
▲●	25
▲●	10

■ A1 / ▲ A2 / ● A4 | SU: Sales unit | All measurements in mm | Other dimensions on request.

Example item no. 9021-2-8,4 DIN 9021 - A2 - Ø 8,4mm