

sim. ISO 10511 - **DIN 985**  
**Prevailing torque type hexagon nuts**  
 with non-metallic insert, thin type

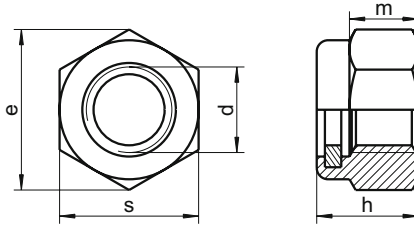

d	m	h	s	e	⌀
M2,5	3,5	2,3	5	5,50	5
M3	2,4	2,4	5,5	6,01	5,5
M4	2,9	2,9	7	7,66	7
M5	3,2	3,2	8	8,79	8
M6	4,0	6,0	10	11,05	10
M8	5,5	8,0	13	14,38	13
M10	6,5	10,0	17	18,90	17
M12	8,0	12,0	19	21,10	19
M14	9,5	14,0	22	24,49	22
M16	10,5	16,0	24	26,75	24
M18	13,0	18,5	27	29,56	27
M20	14,0	20,0	30	32,95	30
M22	15,0	22,0	32	35,03	32
M24	15,0	24,0	36	39,55	36
M27	17,0	27,0	41	45,20	41
M30	19,0	30,0	46	50,85	46
M33	22,0	33,0	50	55,37	50
M36	25,0	36,0	55	60,79	55

Grade	SU
▲●	1000
▲●	1000
▲●	1000
▲●	1000
▲●	500
▲●	200
▲●	100
▲●	100
▲●	100
▲●	50
▲●	50
▲●	50
▲●	25
▲●	25
▲●	25
▲●	25
▲●	25
▲●	25

■ A1 / ▲ A2 / ● A4 | SU: Sales unit | All measurements in mm | Other dimensions on request.  
 Example item no. 985-2-8 DIN 985 - A2 - M8