

DIN 6334

Hexagon nuts

height = 3xd

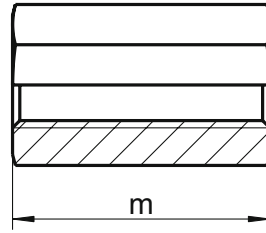
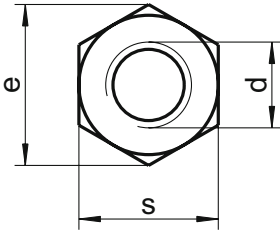

d	m	s	e	⌀
M5	15	8	9,0	8
M6	18	10	11,1	10
M8	24	13	15,0	13
M10	30	17	19,6	17
M12	36	19	21,9	19
M16	48	24	27,7	24
M20	60	30	34,6	30
M24	72	36	41,6	36
M30	90	46	53,1	46

Grade	SU
▲ ●	100
▲ ●	100
▲ ●	100
▲ ●	100
▲ ●	50
▲ ●	50
▲ ●	10
▲ ●	10
▲ ●	10

■ A1 / ▲ A2 / ● A4 | SU: Sales unit | All measurements in mm | Other dimensions on request.

Example item no. 6334-2-8 DIN 6334 - A2 - M8