

DIN 6331

Hexagon nuts

with collar, height = 1,5xd

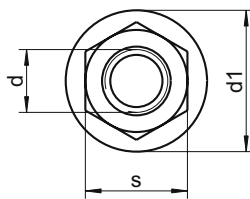
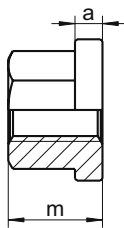

d	m	s	e	d1	a	⬠
M6	9	10	11,05	14	3,0	10
M8	12	13	14,38	18	3,5	13
M10	15	16	17,77	22	4,0	16
M12	18	19	20,03	25	4,0	19
M16	24	24	26,75	31	5,0	24
M20	30	30	33,53	37	6,0	30
M24	36	36	39,98	45	6,0	36
M30	45	45	51,28	58	8,0	45
M36	54	54	61,31	68	10,0	54

Grade	SU
▲●	50
▲●	50
▲●	50
▲●	50
▲●	25
▲●	25
▲●	10
▲●	10
▲●	10

■ A1 / ▲ A2 / ● A4 | SU: Sales unit | All measurements in mm | Other dimensions on request.

Example item no. 6331-2-8 DIN 6331 - A2 - M8