



Vantskruv krok/ögla stål, AISI 316

M8246-C TECHNICAL SPECIFICATIONS

Turnbuckles have a **right-hand** and a **left-hand thread** and are used by turning in one direction or the other to **tighten, loosen** or adjust cable or chain connections. We have the turnbuckles in the version with eyes on both

Material	Stainless Steel
Material class	A4 - AISI 316
Surface	electro polished
Type	eye / hook
Gewinde	Metric Iso thread Eye = right hand thread Hook = left hand thread

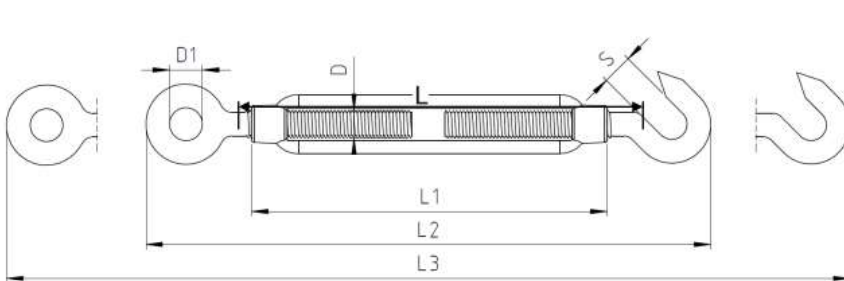

Thread-Ø D	L1 mm	L2 mm	L3 mm	D1 mm	S mm	WLL kg	BL kg
M5	70	120	165	8	7,5	140	560
M6	90	150	205	10	9	200	815
M8	120	200	275	14	12	385	1.550
M10	150	240	345	16	13	560	2.240
M12	200	310	450	18	14	800	3.200
M16	250	390	580	26	18	1.475	5.900
M20	300	440	680	30	20	2.300	9.350

WLL = Working Load Limit

BL = Breaking Load