

EPDM Rubber gasket  
ref. PL-03

U round handrail  
d. 42,4 mm ref. RP-1400

Sealed with polymer SP-101

Glass 16,76-21,52

Wedge and rubber set  
for glass ref. PL-14

Sheet cladding  
ref. PM-55

Base shoe profile fascia-  
mount ref. SV-1402

±10

Max. 1200

Anchor bolts FH II S 12/25  
or similar

Concrete C25/30

FFL

70

107

151

A

68

KEY:

	Stainless steel
	Glass
	Aluminium
	Nylon Polyamide
	PVC
	EPDM
	Concrete

Note:  
PL-14 is a set of spacers,  
wedges and gaskets.

Finished floor level

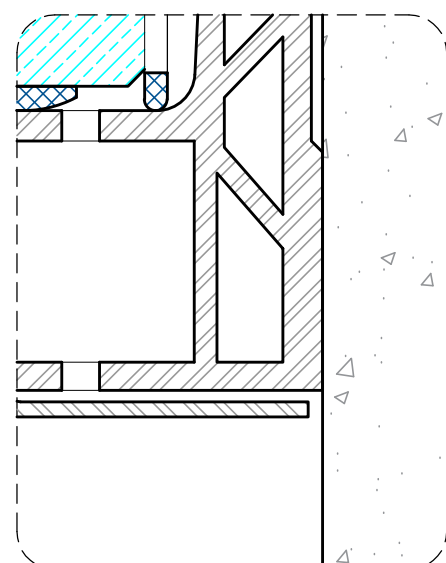

Detail A. Drainage  
Scale 1:4

All dimensions are showed in milimeters (mm)

Due to the broad diversity of materials existing on the market and the different application methods outside of our control, we recommend in any case to do physical tests and sufficient controls to ensure the suitability of the product in each specific application.  
It is the responsibility of the user to establish the suitability of the information provided with their particular use of the product.

It is prohibited to make total or partial reproductions, as well as copies, without the written authorisation of Comenza.  
COPYRIGHT: COMENZA SL (2016)

Scale:	1:2	Format:	UNE A-3	System	GlassFit SV-1402 Side
Author:	Technical office			Model:	COMENZA_GlassFit SV-1402 Side_U round handrail RP-1400_R0_M
Date:	01/09/2016			Plan:	General details
Customer:	N/A				
Project:	N/A				



Nº Plan  
1 / 1