

DIN 125 A - sim. ISO 7089

Plain washers

type A without chamfer

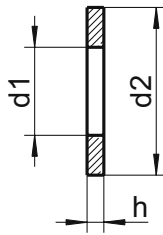
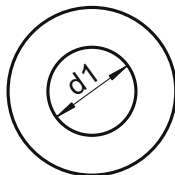

d1	for	d2	h
1,7	M1,6	4,0	0,3
1,8	M1,7	4,5	0,3
2,2	M2	5,0	0,3
2,5	M2,3	6,0	0,5
2,7	M2,5	6,0	0,5
2,8	M2,6	7,0	0,5
3,2	M3	7,0	0,5
3,7	M3,5	8,0	0,5
4,3	M4	9,0	0,8
5,3	M5	10,0	1,0
6,4	M6	12,0	1,6
7,4	M7	14,0	1,6
8,4	M8	16,0	1,6
10,5	M10	20,0	2,0
13,0	M12	24,0	2,5
15,0	M14	28,0	2,5
17,0	M16	30,0	3,0
19,0	M18	34,0	3,0
21,0	M20	37,0	3,0
23,0	M22	39,0	3,0
25,0	M24	44,0	4,0
28,0	M27	50,0	4,0
31,0	M30	56,0	4,0
34,0	M33	60,0	5,0
37,0	M36	66,0	5,0
40,0	M39	72,0	6,0
43,0	M42	78,0	7,0
46,0	M45	85,0	7,0
50,0	M48	92,0	8,0
52,0	M50	92,0	8,0
54,0	M52	98,0	8,0

Grade	SU
▲●	1000
▲●	1000
▲●	1000
▲●	1000
▲●	1000
▲●	1000
▲●	1000
▲●	1000
▲●	1000
▲●	1000
▲●	1000
▲●	1000
▲●	1000
▲●	1000
▲●	1000
▲●	500
▲●	500
▲●	200
▲●	200
▲●	200
▲●	200
▲●	200
▲●	100
▲●	100
▲●	50
▲●	25
▲●	25
▲●	10
▲●	10
▲●	10
▲●	10
▲●	10
▲●	10
▲●	10

■ A1 / ▲ A2 / ● A4 | SU: Sales unit | All measurements in mm | Other dimensions on request.

Example item no. 125-2-8,4 DIN 125 - A2 - Ø 8,4mm - form A

Plain washers with 200 HV ISO 7089 can be found on the following pages. Washers for hexagon socket head cap screws can be found as DIN 433 in this catalogue. Polyamid washers can be found as WS 9500, plain washers with an expanded contact surface can be found as DIN 9021 in this catalogue.